

**THIS QUICK TUTORIAL
WILL GUIDE YOU
THROUGH THE STEPS
ON INSTALLING THE
7600WTMU ON THE
AQUASMART
CONTROL**

AquaSmart Wireless Temperature Module Model 7600WTM



It adds outdoor reset capability to the AquaSmart control by overriding the control's built-in HeatManager algorithm when installed.



Remove power from AquaSmart, snap in AWM, restore power.



Remove the internal cartridge containing the battery cell from the Wireless Temperature Sensor (WTS). Press in the plastic tabs and pull the cartridge out.

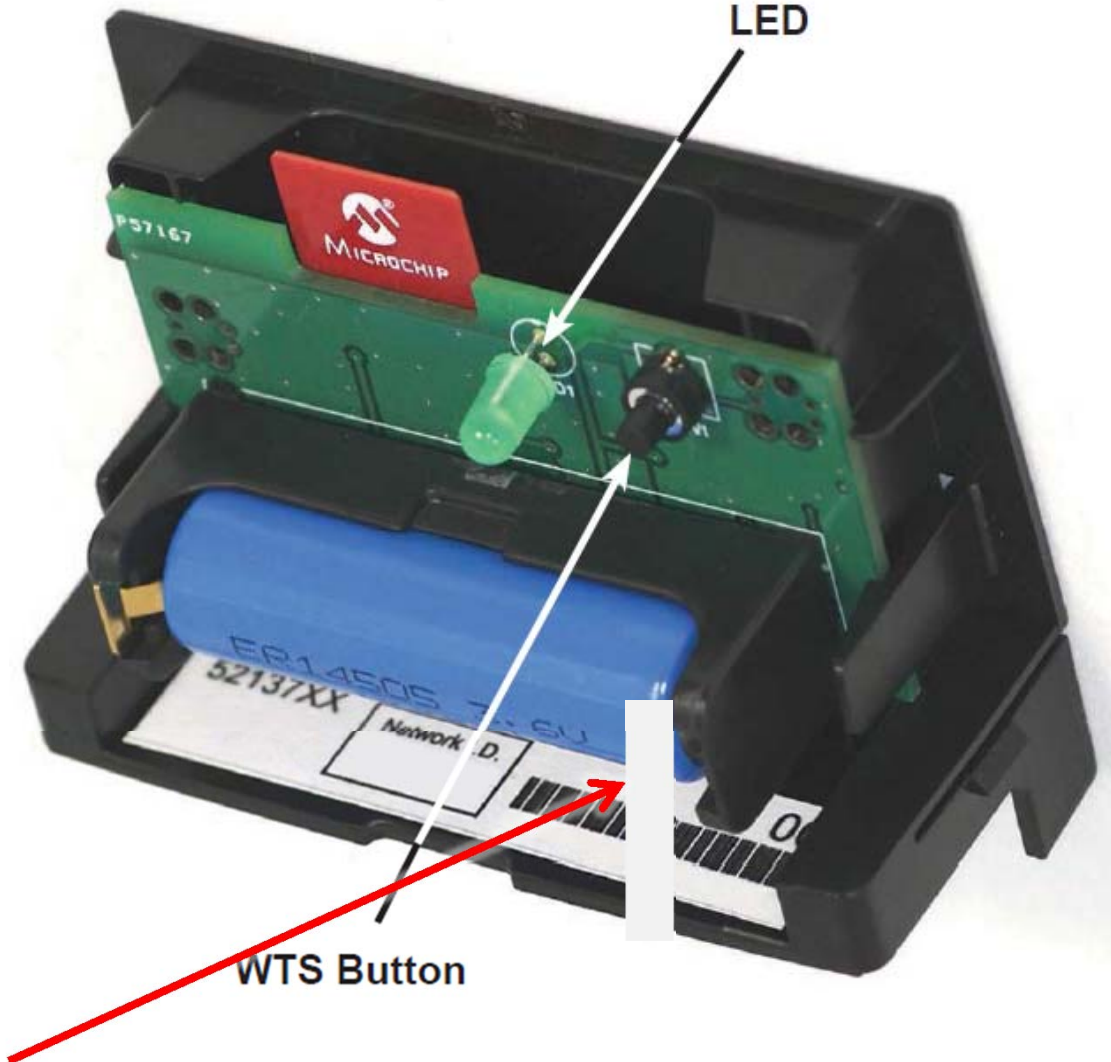

Remove the plastic insert on the battery terminal. Make sure battery is inserted properly (see polarity mark on battery holder).

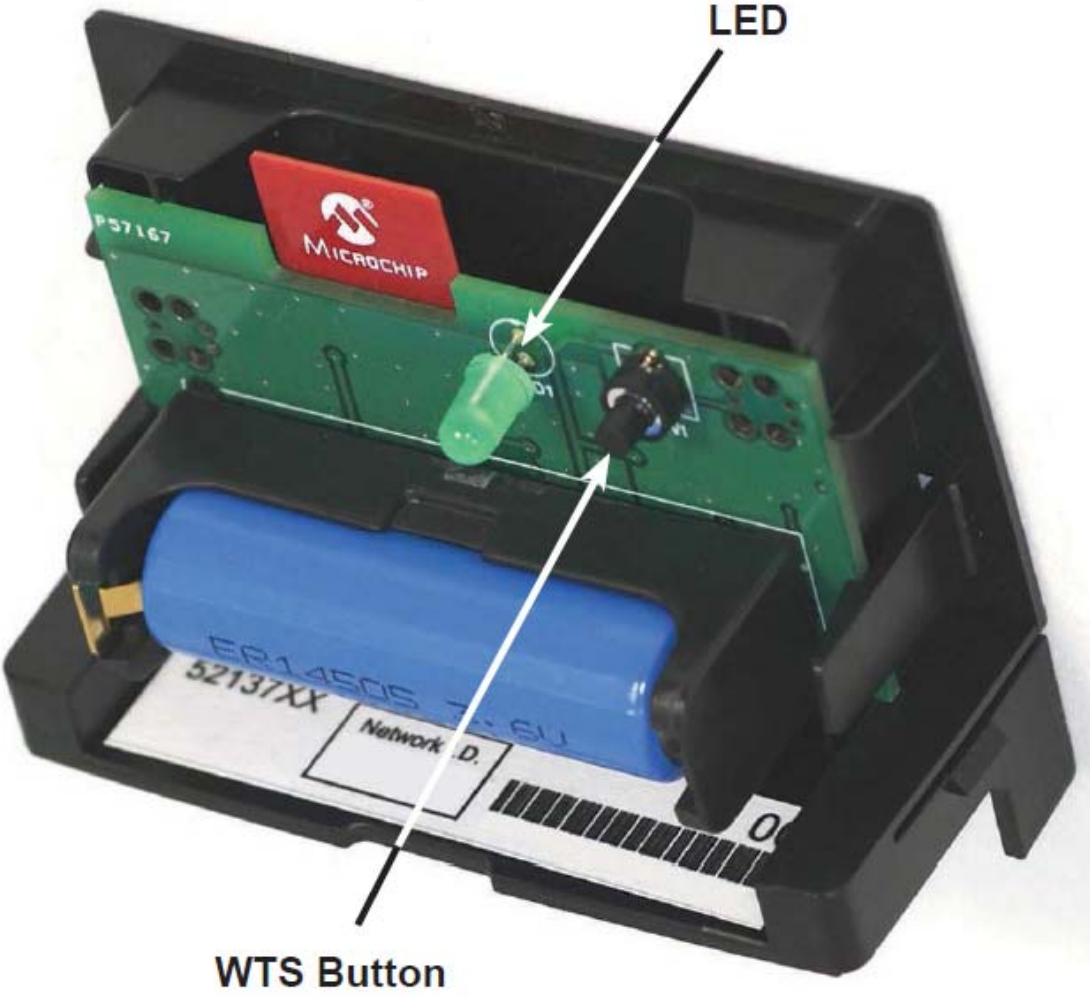

Press the WTS button once The LED should flash five times.

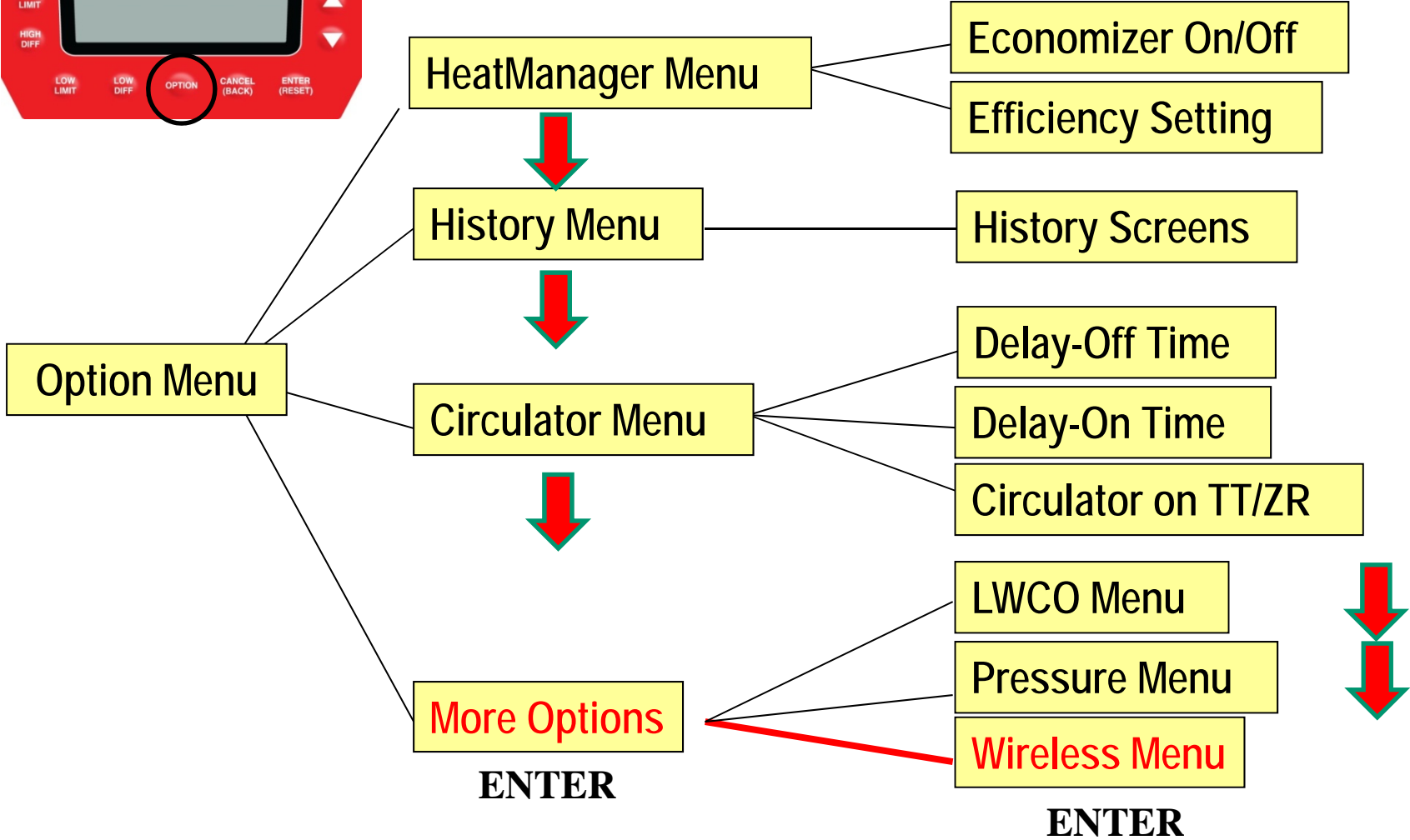
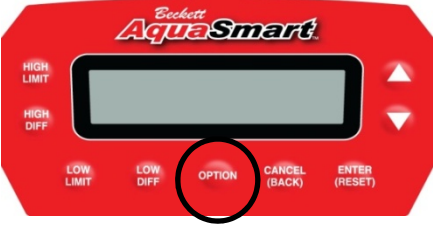

Using the AquaSmart's display, navigate to Screen 1 in the **wireless menu**

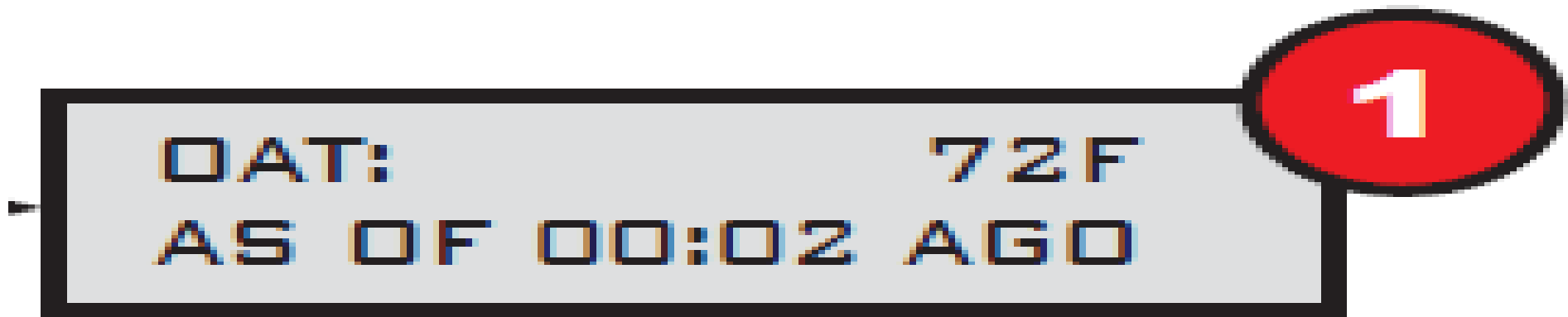

The screen should display the current outdoor temperature and show that the last transmission was received within the last few minutes.

If the OAT screen says **AS OF 18:12 AGO, press the WTS button once.**

If the value does not update, there is a problem with the connectivity of the WTS. Move the WTS to a location closer to the AWM or with less interference.



Navigate to screen 2. The signal strength screen indicates the strength of the connection between the AWM and WTS.

At least 3 darkened bars are recommended for operation, with 6 or more indicating a good connection.



Navigate to Screen 3. If the screen says “REPLACE”, the battery needs replaced.



Navigate to Screen 4. Pressing ENTER (RESET) on this screen will toggle the setting on and off. ON (default) indicates that the outdoor reset algorithm will override the HeatManager™ algorithm.



Navigate to Screen 5. Press ENTER (RESET) on this screen and follow the on-screen instructions to change this setting. This number specifies the outdoor temperature at which the boiler reset temperature will be at its minimum value.



Navigate to Screen 6. Press ENTER (RESET) on this screen and follow the on-screen instructions to change this setting. This number specifies the outdoor temperature at which the boiler high limit will be at its maximum value.



Navigate to Screen 7. Pressing ENTER (RESET) on this screen will toggle the setting on and off. ON will turn the low limit of the AquaSmart off when the outdoor temperature is above 70°F (21°C). Turning this feature on can help to increase fuel savings. OFF (default) will not turn the low limit off based on outdoor temperature.



Navigate to Screen 8. Press ENTER (RESET) on this screen and follow the on-screen instructions to change this setting. This is the OTR's equivalent of the HeatManager's 20 minute kickout function. Every 10 consecutive minutes of CFH or burner on time, the Boost value is added to the adjusted high limit.