

# Propane Restrictor Conversion Kit

## Product Description

The Beckett Propane Restrictor Conversion Kit allows for the conversion of CG10, CG15, CG25, and CG50 burners for use with propane gas. With the proper installation of the restrictor and attached O-ring, adjustments and settings for propane use will be the same as the adjustments and settings for natural gas use as detailed in the burner manual.

### ⚠️ WARNING



This conversion kit shall be installed by a qualified service agency in accordance with the manufacturer's instructions and all applicable codes and requirements of the authority having jurisdiction. (In Canada, in accordance with

the requirements of the CAN/CGA-B149 Installation Code.) If the information in these instructions is not followed exactly, a fire, explosion, or production of carbon monoxide may result causing property damage, personal injury or loss of life. The qualified service agency is responsible for the proper installation of this kit. The installation is not proper and complete until the operation of the converted appliance is checked, as specified in the manufacturer's instructions supplied with the kit.

Please carefully read and comply with the instruction manual supplied with the specific burner being converted.

## Installation

Note that Steps 1 and 2 on the reverse side refer to fully assembled burners. Skip to Step 3 when converting a burner without the air tube assembly installed. Refer to Figures 1 and 2 when performing the following steps.

### NOTICE

CG15 is shown in the illustrations. CG25 and CG50 are similar. CG10 is similar with the exception of having the gas gun assembly mounted into the air tube instead of the housing.

Figure 1 - Components

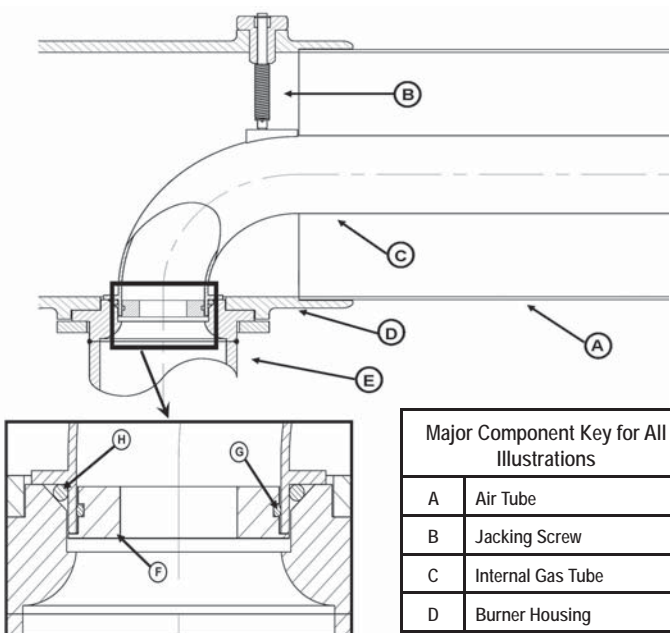

Major Component Key for All Illustrations	
A	Air Tube
B	Jacking Screw
C	Internal Gas Tube
D	Burner Housing

Figure 2 - Assembly Location

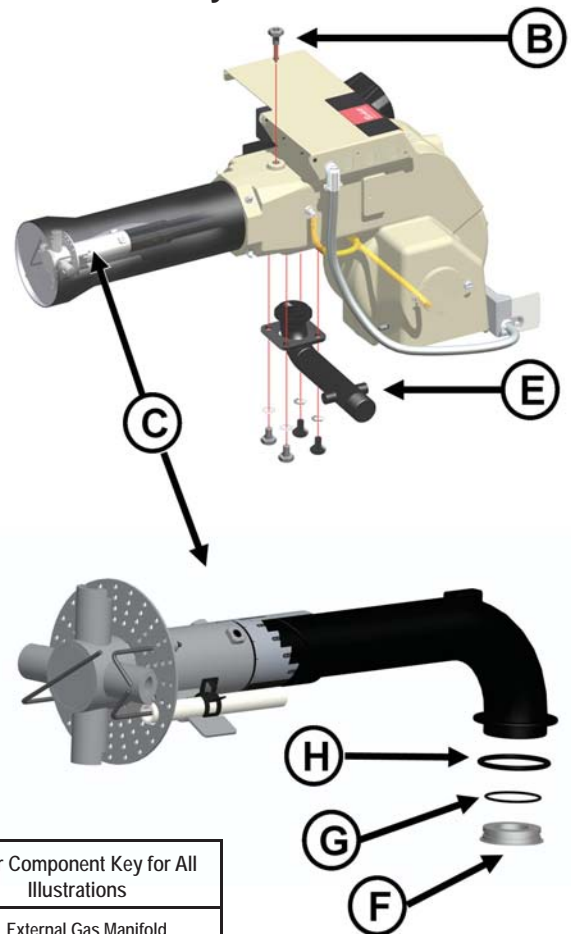

Major Component Key for All Illustrations	
E	External Gas Manifold
F	Propane Restrictor
G	Restrictor O-ring
H	Gas Tube O-ring

**NOTICE**

Use authorized replacement parts only. Restrictors are precision-machined parts and O-rings are rated for fuel contact. Do not attempt to replicate or modify any parts. Refer to **Table 1**.

**NOTICE**

The gun assembly is secured inside the air tube by a spring-loaded jacking screw. It is spring loaded in order to control the force it can impose on the gun assembly. When installing the jacking screw look inside the air tube to verify that the pointed tip of the jacking screw pin is seated into the small slot on the locating pad on top of the gun. There is also an external verification of correct assembly: when the screw is fully tightened, the e-clip on the top of the center pin should come flush with the top of the screw. Refer to **Figure 3**.

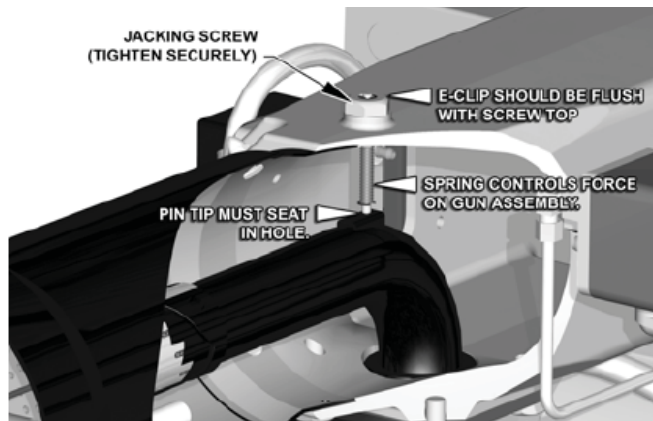
**Figure 3 - Gas Gun Installation**

1. Remove the jacking screw (**B**) from the housing to free the internal gas tube (**C**).
2. Gently rock the internal gas tube (**C**) to loosen the tube from the burner housing (**D**).
3. Inspect the O-rings and insure that they are properly lubricated. (A silicon O-ring lubricant is recommended, but automotive chassis or bearing grease is an acceptable substitute.)
4. Referring to **Figure 2**, place the restrictor (**F**) with pre-attached, pre-lubricated O-ring (**G**) into the internal gas tube (**C**). Use your hand to press the restrictor into the tube. The O-ring will hold the restrictor in place.
5. Insure that the O-ring (**H**), attached to the outside diameter of internal gas tube, is properly lubricated and seated against the flange on the internal gas tube.
6. Install the internal gas tube (**C**) back into the housing, refer to **Figure 1**. Fit the end of the tube into the external gas manifold (**E**).
7. Re-install the jacking screw (**B**). (Refer to the above notice for installation details.)
8. Fill out and place the supplied Conversion Data Plate adjacent to the rating plate.
9. Complete and attach the supplied Adjustment Data

**NOTICE**

With the gas restrictor installed, as shown in **Figures 1 & 2**, all burner air adjustments and gas manifold pressure adjustments for propane will be approximately the same as the natural gas adjustments shown in the burner manual, or printed on the "Mfr's Settings" label on the burner housing. For a copy of the current burner manual go to <http://www.beckettcorp.com/protect/tech.asp>. If further Technical assistance is required, call 800-645-2876, Monday thru Friday, 8AM to 5PM EST.

**Table 1 - Replacement Part Numbers**

Burner Model	Restrictor Part Number	Restrictor Inside Diameter	O-Ring Part Number
CG10.1	3246700U	0.401	3226409U
CG10.2	3246701U	0.432	3226409U
CG10.3, CG10.2S	3246702U	0.470	3226409U
CG10.1S	3246703U	0.418	3226409U
CG10.3S, CG10.6S	3246705U	0.510	3226409U
CG10.4S	3246706U	0.459	3226409U
CG10.5S	3246707U	0.482	3226409U
CG15.1S	3246709U	0.532	3226401U
CG15.2S	3246710U	0.576	3226401U
CG15.3S	3246711U	0.623	3226401U
CG15.4S	3246712U	0.677	3226401U
CG25.1S	3246713U	0.712	3226402U
CG25.2S	3246714U	0.742	3226402U
CG25.3S	3246715U	0.796	3226402U
CG25.4S	3246716U	0.833	3226402U
CG25.5S	3246717U	0.889	3226402U
CG50.1S	3246718U	0.925	3226403U
CG50.2S	3246719U	0.980	3226403U
CG50.3S	3246720U	1.031	3226403U
CG50.4S	3246721U	1.103	3226403U
CG50.5S	3246722U	1.150	3226403U